

# DIN 69871

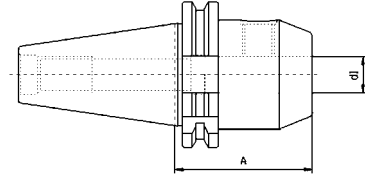

SK	d mm	A mm	Art.-Nr. / Order no.
SK 50	25	80	● 13-7625-50-25-80
SK 50	25	100	▶ 13-7625-50-25-100
SK 50	25	160	▶ 13-7625-50-25-160
SK 50	32	100	● 13-7625-50-32-100
SK 50	32	160	▶ 13-7625-50-32-160
SK 50	40	120	● 13-7625-50-40-120

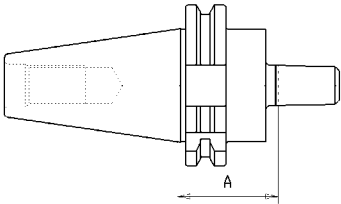

## Bohrfutteraufnahmen DIN 69871 Drill chuck adaptors DIN 69871

SK	Kegel / Taper	A mm	Art.-Nr. / Order no.
SK 40	B12	40	● 13-5374-40-B12
SK 40	B16	40	● 13-5374-40-B16
SK 40	B18	40	● 13-5374-40-B18
SK 50	B16	40	● 13-5374-50-B16
SK 50	B18	40	● 13-5374-50-B18

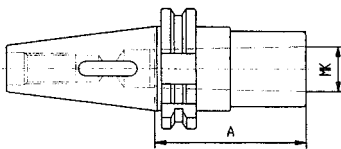

## Zwischenhülsen DIN 69871 für MK-Werkzeuge mit Aus- treiblappen Reducing adaptors DIN 69871 for MT tools with tang

SK	MK / MT	A mm	Art.-Nr. / Order no.
SK 40	1	50	● 13-1681-40/1
SK 40	2	50	● 13-1681-40/2
SK 40	3	70	● 13-1681-40/3
SK 40	4	95	● 13-1681-40/4
SK 50	1	45	▶ 13-1681-50/1
SK 50	2	50	● 13-1681-50/2
SK 50	3	65	● 13-1681-50/3
SK 50	4	95	● 13-1681-50/4
SK 50	5	100	● 13-1681-50/5

## Zwischenhülsen DIN 69871 für MK-Werkzeuge mit Anzugs- gewinde Reducing adaptors DIN 69871 for MT tools with thread

- mit Anzugsgewinde DIN 6364

- with thread DIN 6364

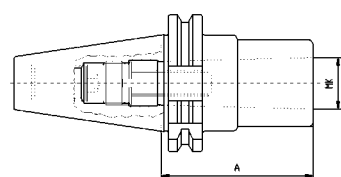

SK	MK / MT	A mm	Art.-Nr. / Order no.
SK 40	1	50	● 13-1695-40/1
SK 40	2	50	● 13-1695-40/2
SK 40	3	70	● 13-1695-40/3
SK 40	4	95	● 13-1695-40/4
SK 50	1	45	▶ 13-1695-50/1
SK 50	2	60	● 13-1695-50/2
SK 50	3	65	● 13-1695-50/3
SK 50	4	95	● 13-1695-50/4
SK 50	5	105	● 13-1695-50/5